

PURCELL 1451 SQUARE FEET / 2 BEDROOMS / 2.5 BATHS

PURCELL PLUS 2002 SQUARE FEET / 2 BEDROOMS / 2 BATHS & 2 HALF BATHS

PURCELL

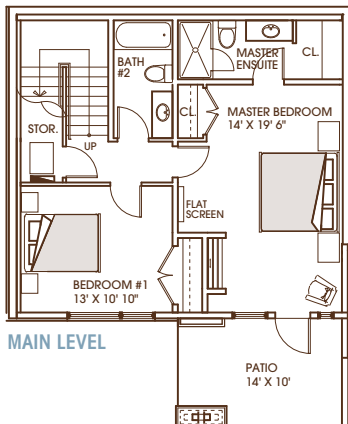
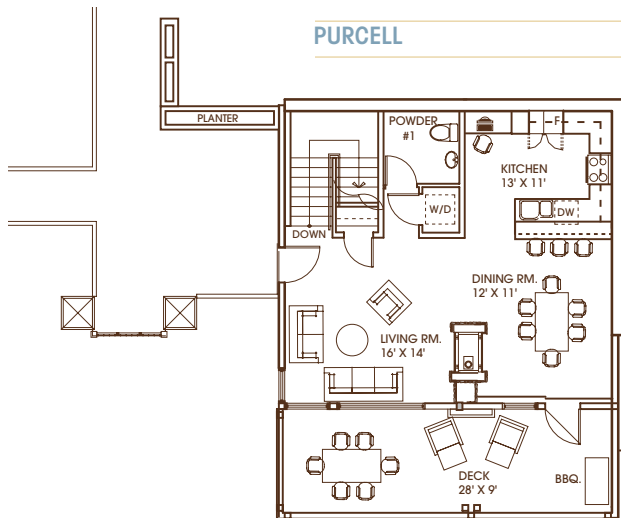

PURCELL PLUS

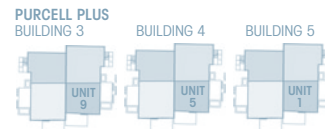
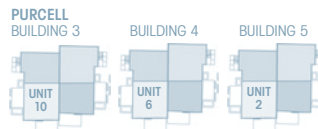
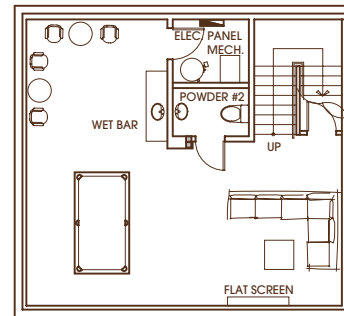

TOWNHOME FEATURES

- Eco-sensitive energy efficient design
- Oversize outdoor living spaces
- Exquisitely furnished and fully equipped
- Leather sofa in living rooms
- Gienow Energy Star low-e argon oversize windows
- Harristone cultured stone work, including patio
- Durable HardiePlank siding
- Spacious entry and common area decking, walkways and entry
- Designed for cross-ventilation cooling
- Xeriscape native landscaping
- Zero maintenance Duradeck flooring on entertainment decks
- Professional on-site management team

LIVING AREA

- Tile entry area with hardwood flooring in living area
- Plush carpeted stairs and bedrooms
- Heated tile flooring in ensuite
- Natural fir doors and trim
- Fireplace: cultured stone base; rock capped with fir mantle
- TV / Home theatre
- Pool table and 50" TV in media/recreation space (*Purcell Plus*)
- Ceiling fan and air conditioned
- Fibre optics and Cat 6 wiring throughout

KITCHEN

- Premium stainless steel appliances (Energy-star rated)
- Dimmable halogen pot lights
- Valence lighting under kitchen cabinets
- Granite counter top
- Fir top eating bar
- Granite sinks in kitchen (double sink)
- Custom hardwood cabinetry
- Computer station
- Inhouse washer and dryer

BEDROOM

- Master Bedroom: reading pot lights; dimmer switches
- Pedestal sinks in Powder Room
- King size bed in Master
- Deluxe majestic pillow top mattresses
- Lo-flow faucets and toilets
- TV and ipod dock with clock radio in Master

PRIVATE OWNERS CLUB

- Private owners lounge, media room and fully-equipped gym
- Cascading waterfall
- Outdoor hot pools, BBQ, sauna, relaxation decks and children's play area

The developer reserves the right to make improvements and adjustments to these homes.

1.250.345.6095
FAIRMONT.RIDGE.CA

